

## Step 1

### Outside Recess

If the blind is to be fitted outside the window, ensure that measurement **C** is the same. **C** is simply equal to **A** minus **B**, divided by two. Follow instructions for FACE FIXING.

### Inside Recess

If TOP FIXING, fix to the lintel if the window frame is uPVC, or if there are no obstructions. If FACE FIXING, fit bracket to the window frame.

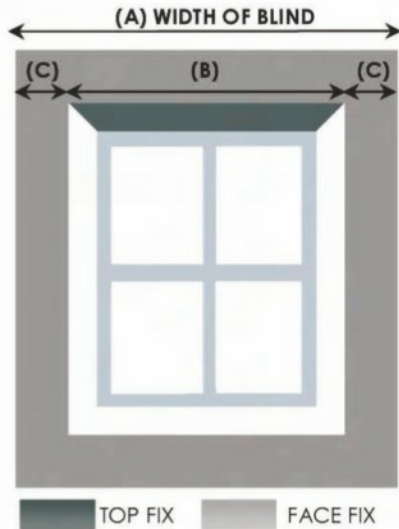

## Step 2

Hold each bracket into place and mark the hole positions. Fit each bracket using 2 screws provided.

### TOP FIXING

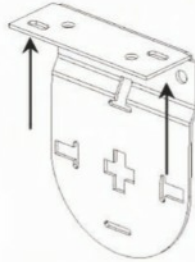

### FACE FIXING

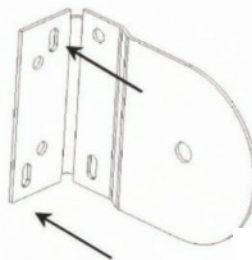

## Step 3

Holding the fully-wound blind, insert the idle pin end into the bracket as shown.

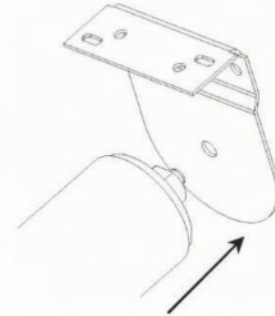

With the idle pin end in place, insert the control end into the opposite bracket. Ensure that the blind has clicked into place using the centre lug.

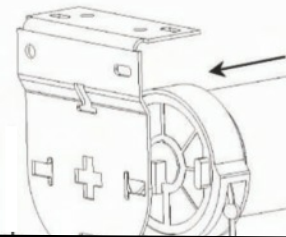

## Step 4

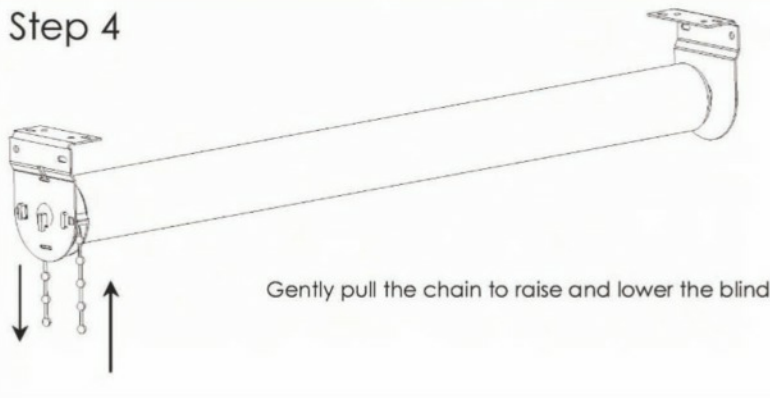

Please see overleaf for instructions on fitting the optional pelmet

# HOW TO FIT THE SENSES PVC PELMET TO OUR ROLLER BLIND

Fix the metal fixing brackets on the normal way. (Note that these must be with top fixed or face fixed - side fixing is not possible as the screws will obstruct the end cap brackets). If fixing within a window recess you should allow a small gap between the wall end the side of the bracket to allow the end cap brackets to be fitted

The left and right end cap brackets should then be slid into the metal brackets as shown in Fig. 1  
Once these are in place the PVC Fascia with the fabric insert  
in simply clicked into the 2 end caps as shown in Fig 2



Fig 1



Fig 2

**FOR FURTHER ADVICE OR ASSISTANCE PLEASE CONTACT US**  
**Tel 0800 098 8823 or 01733 592012 Email [sales@blinds247.com](mailto:sales@blinds247.com)**

